

REVISIONS

CONSULTANT  
LINK-NILSEN CORPORATION  
130 E. SANTA CLARA ST.  
ARCADIA, CA 91006  
626-445-3414  
CONTACT:  
MICHAEL GLASOW



NORWALK LA MIRADA UNIFIED SCHOOL DISTRICT  
LA MIRADA HIGH SCHOOL NEW  
FOOTBALL STADIUM PROJECT  
13520 ADELFA DRIVE LA MIRADA, CA 90638

DSA # 03-120551

**NAC**  
ARCHITECTURE

NAC NO. 161-19015  
DATE 08-26-2020

DSA BACKCHECK  
SUBMISSION

BUILDING W - PIPING / RCP

**FP3.11**

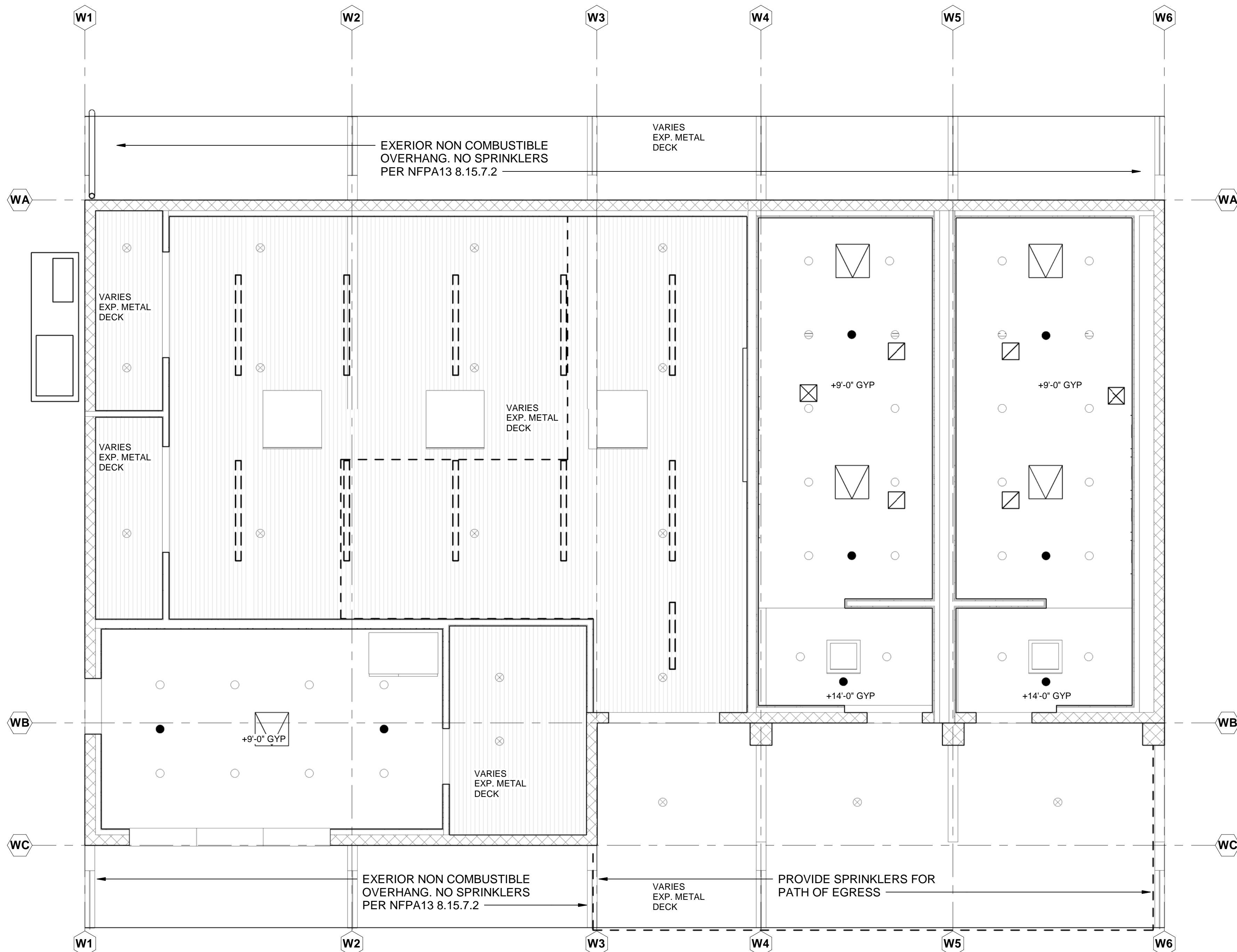

BUILDING W - VISITOR FIELD HOUSE  
FIRE SPRINKLER RCP  
1/4" = 1'-0"

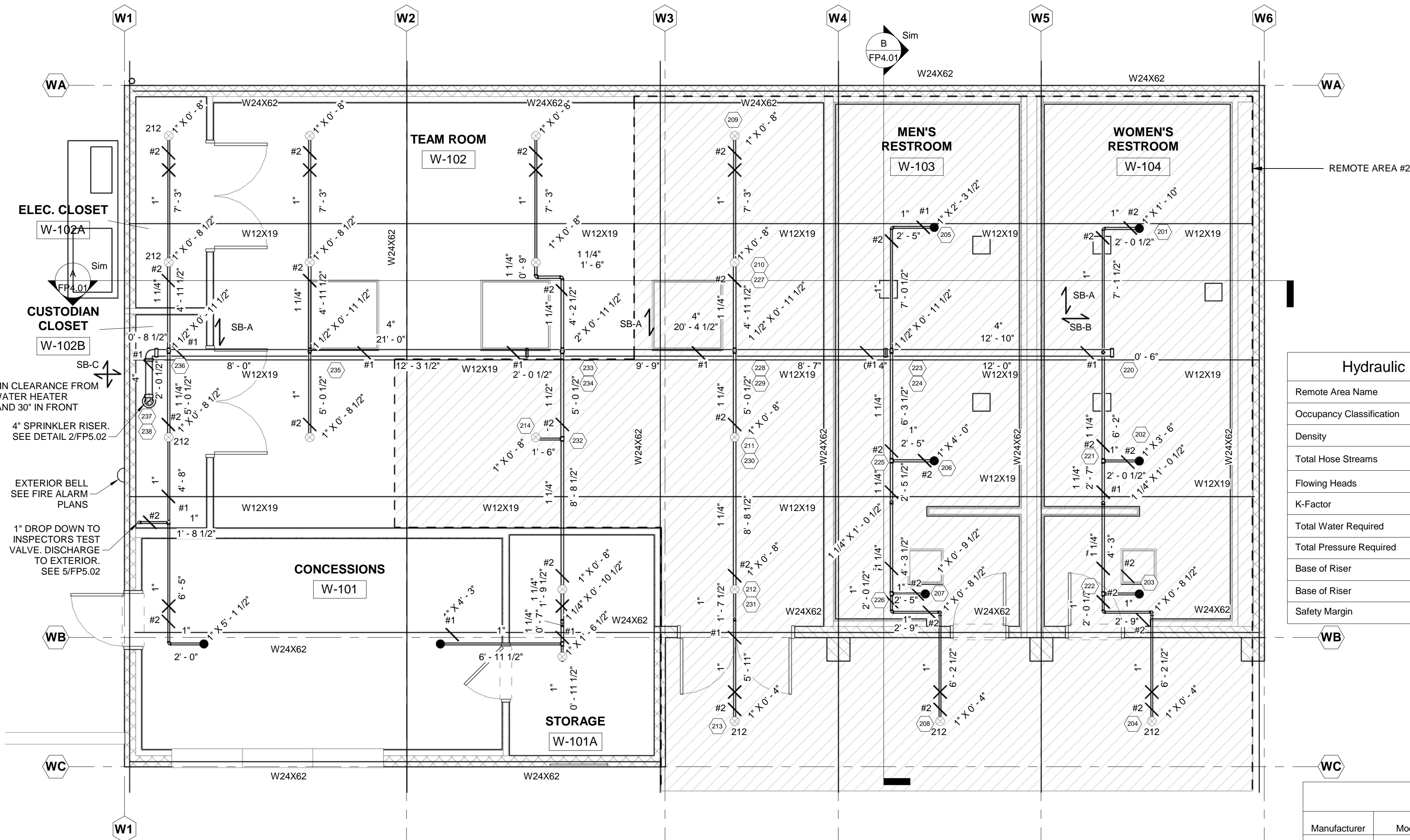

BUILDING W - VISITOR FIELD HOUSE  
FIRE SPRINKLER PIPING PLAN  
1/4" = 1'-0"

Hydraulic Information

Remote Area Name	RA 2
Occupancy Classification	Light Hazard
Density	0.10 GPM
Total Hose Streams	100.00 GPM
Flowing Heads	14 @ 14.82 GPM
K-Factor	5.6
Total Water Required	348.96 GPM
Total Pressure Required	34.17 psi
Base of Riser	348.96 GPM
Base of Riser	34.17 psi
Safety Margin	+7.67 (18.33%)

Sprinkler Schedule Building U

Manufacturer	Model	S.I.N.	K-Factor	Orifice Size	Response	Type	Finish	Escutcheon	Temperature Rating	Count
Reliable	GS-56	RA3415	5.6	1/2"	Quick	1/2" Pendent	White	Concealed	165 °F	8
Reliable	KFR56	RA3624	5.6	1/2"	Quick	1/2" Upright	White Poly	None	165 °F	18
Grand total: 26										

NOTE: ALL SPRINKLERS SHALL BE 165 DEG. F. UNLESS NOTED 212